

卡式刀座 90° CARTRIDGES (90°)

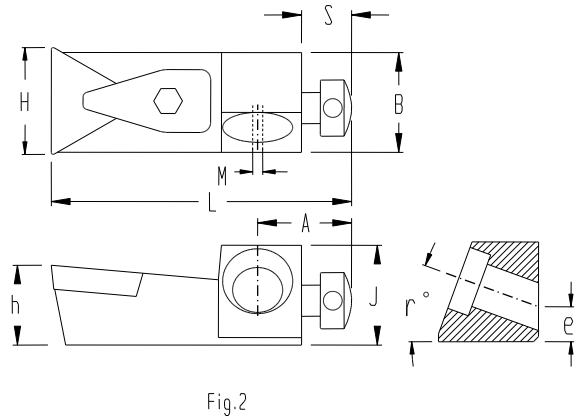
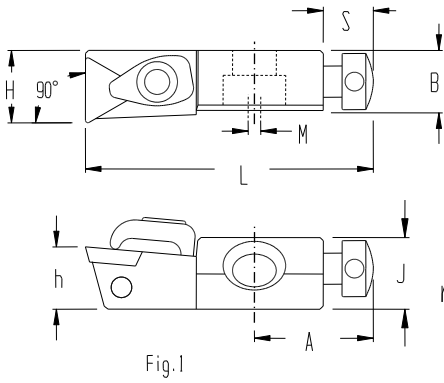

| 規格 SPECIFICATION | H | h | L | A | J | B | r° | e | M | S | 最小加工徑 Min.Bore φD | 圖 Fig |
|---------------------|-------|----|----|-------|------|------|-----|------|---|---|----------------------|----------|
| CTFER-08CA-11 | 11.6 | 10 | 46 | 19 | 11.5 | 10 | 8° | 5.65 | 2 | 8 | 35 | *1 |
| CTFPR-10CA-11 | 14 | 10 | 50 | 20 | 15 | 11 | 20° | 5 | 2 | 8 | 38 | |
| CTFPR-12CA-16 | 20 | 12 | 55 | 20 | 16 | 14.5 | 20° | 6 | 2 | 8 | 50 | |
| CTFPLX16-22 | 21.41 | 16 | 57 | 15.76 | 20 | 20 | 20° | 7 | 2 | 7 | | *2 |

部品 PARTS

| 規格 SPECIFICATION | 適用刀片 INSERTS | 壓版+螺絲 CLAMP +SCREW | 徑向調整螺絲 RADIAL ADJUSTING SCREW | 軸向調整螺絲 AXIAL ADJUSTING SCREW | 鎖固螺絲 LOCKING SCREW |
|---------------------|--|---|--|--|--------------------------|
| CTFER-08CA-11 |  TEGN110204 |  172.9-826-1 |  RS0408 |  AS040 | LS0516 (M5) |
| CTFPR-10CA-11 |  TPGN110304 |  FC1308-4 +CS0412 |  RS0410 |  AS040 | LS0620 (M6) |
| CTFPR-12CA-16 |  TPGN160304 |  CPS-5R |  RS0512 |  AS050 | |
| CTFPX16-22 |  TPGN220404 |  FC2512-6 +CS0616 | - |  AS040 | LS0825 (M8) |